

## Rotary Truss Clamp

**Max Load: 500kg / 1100 lb**

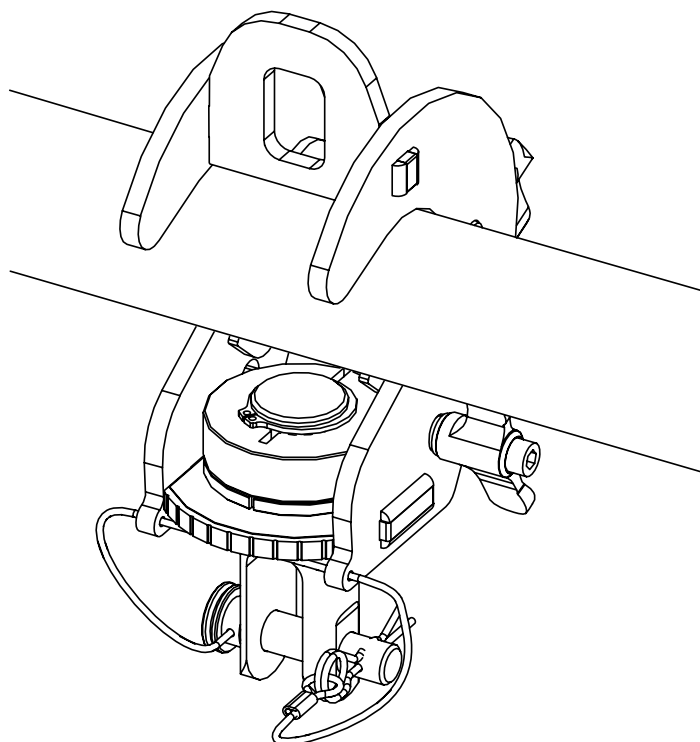

### Contents:

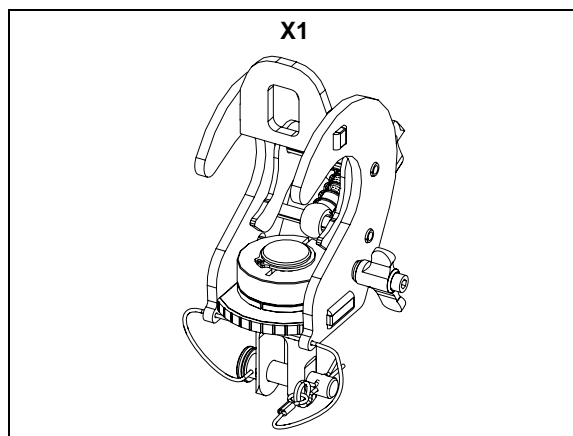

**Weight: 2 kg / 4.4 lb**



nexo-sa.com

ZA du Pre de la Dame Jeanne  
60128 PLAILLY - France

- Read this document before using.
- Keep this document.
- Observe all warnings and cautions.



**Dimensions:**

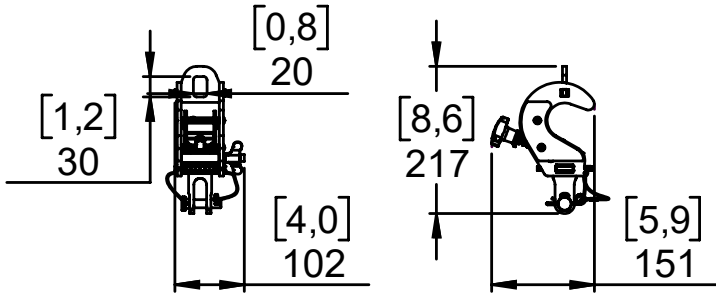

**WARNINGS**

Ensure that the mounting location and fasteners can support at least 4 times the weight of all the installed cabinets, auxiliary equipment and cables.

Max Load: 500 kg / 1100 lb

**Use:**

Tighten the knob on the back to fix on the tube (diameter from 35 to 51 mm)

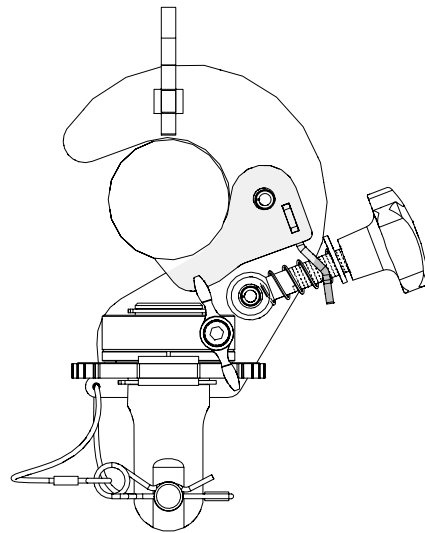
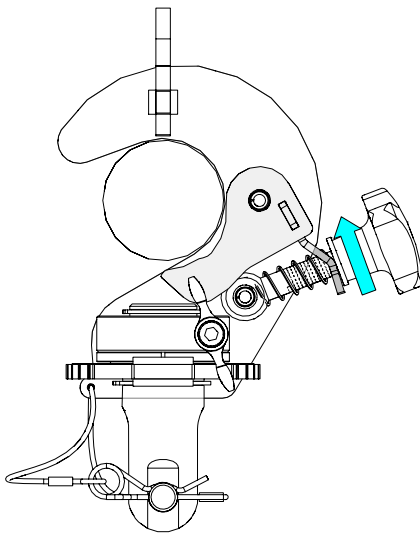

Loosen the knob on the side to adjust the rotation. Tighten to lock

Use this point to secure the hanging.

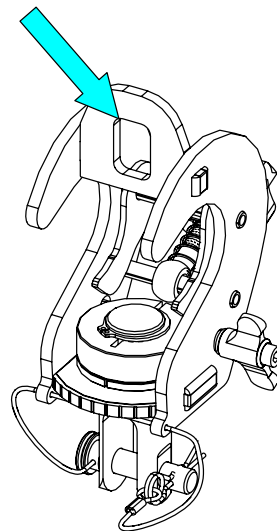
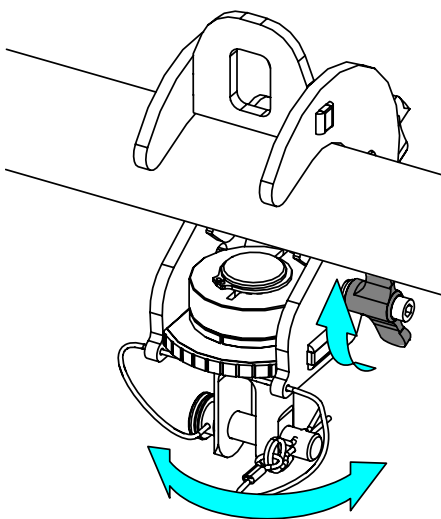

**NEXO**

nexo-sa.com

ZA du Pre de la Dame Jeanne  
60128 PLAILLY - France

- Read this document before using.
- Keep this document.
- Observe all warnings and cautions.



## Application cases:

GMT-BUMPER (max: 12x GEOM6)

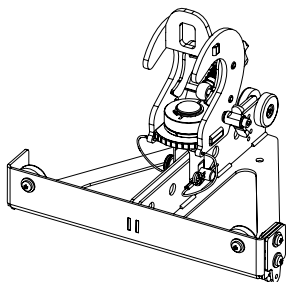

GMT-LBUMPM10 (with its shackle)

Max: 12x GEOM10

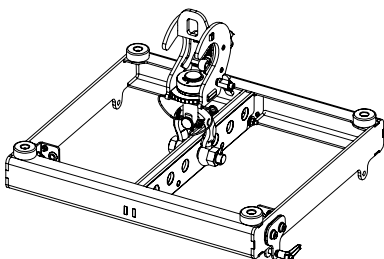

GMT-LBUMPM10 / GMT-EXBARM10L (with its shackle)

Max: 12x GEOM10

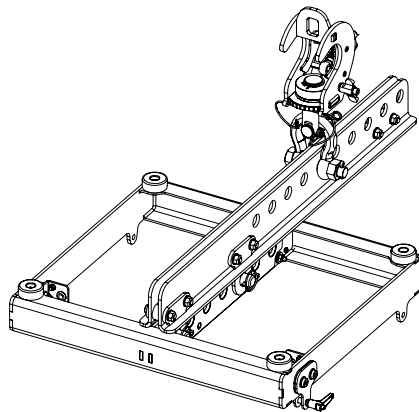

GMT-LBUMPM12 (with its shackle)

Max: 12x GEOM12

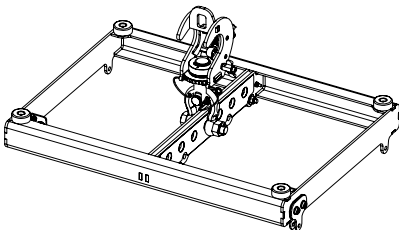

GMT-LBUMPM12 / GMT-EXBARM12L (with its shackle)

Max: 12x GEOM12

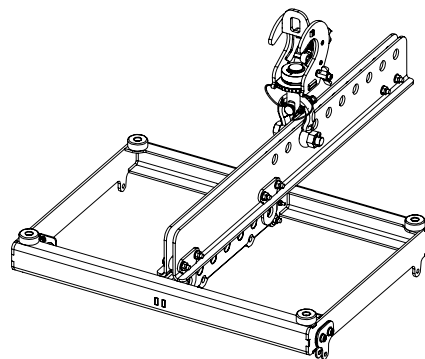

With IDU-BUMP (Max: 4xID84)

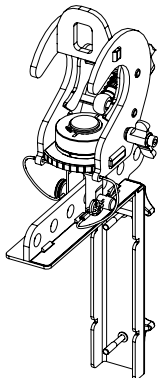

With VNU-BUMP

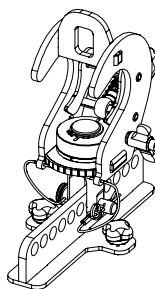

# NEXO

nexo-sa.com

ZA du Pre de la Dame Jeanne  
60128 PLAILLY - France

- Read this document before using.
- Keep this document.
- Observe all warnings and cautions.



STT-LBUMPM28 (with its shackle)

Max: 6x M28

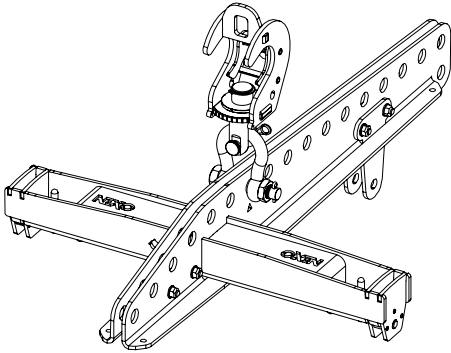

VNT-BUMPM6

Max: 12x GEOM6, or 8x MSUB12, or  
 $NGEOM6 + 1.5NMSUB12 \leq 12$

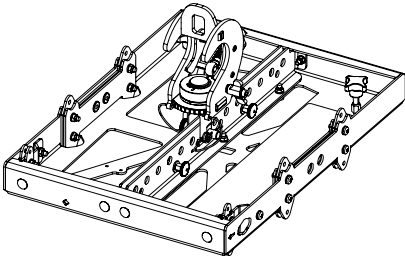

VNT-BUMPM6 / VNT-EXBARM6

Max: 12x GEOM6, or 8x MSUB12, or  
 $NGEOM6 + 1.5NMSUB12 \leq 12$

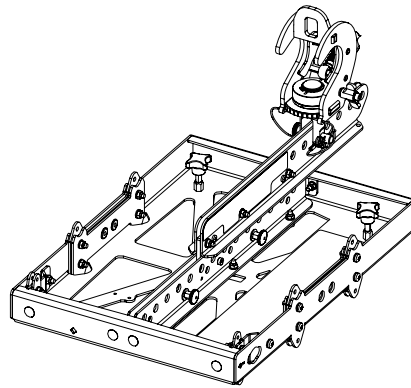

VNI/VNT-BUMPM10 / VNT-EXBARM10 (with its shackle)

Max: 12x GEOM10, or 8x MSUB15, or  
 $NGEOM10 + 1.5NMSUB15 \leq 12$

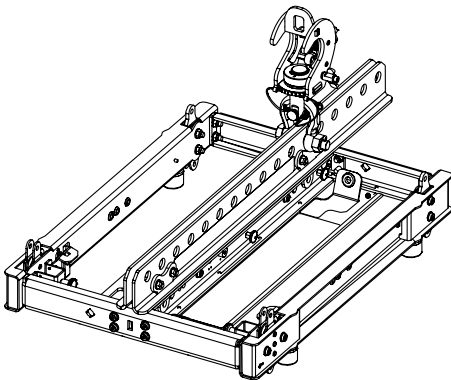

VNI/VNT-BUMPM12 / VNT-EXBARM12 (with its shackle)

Max: 12x GEOM12, or 8x MSUB18, or  
 $NGEOM12 + 1.5NMSUB18 \leq 12$

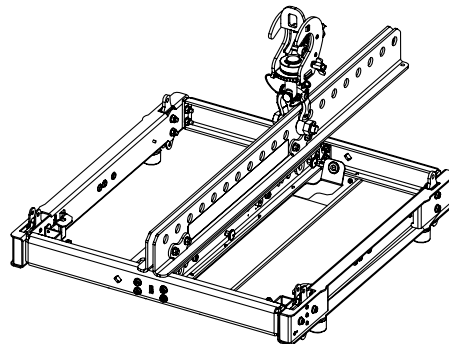

- NEXO cannot accept responsibility for accidents caused by any factor other than defects in this product itself.
- Please check the web site [nexo-sa.com](http://nexo-sa.com) for the latest update.

**NEXO**

[nexo-sa.com](http://nexo-sa.com)

ZA du Pre de la Dame Jeanne  
60128 PLAILLY - France

- Read this document before using.
- Keep this document.
- Observe all warnings and cautions.

