

ID84 / ID84L

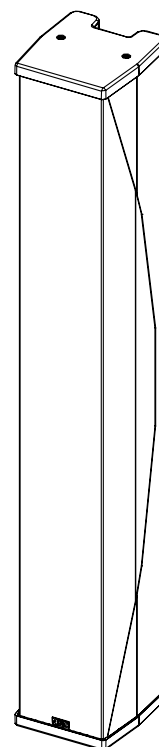

User manual

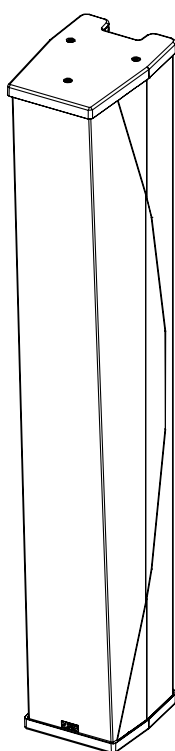

TABLE OF CONTENTS

| | |
|--------------------------|----|
| TABLE OF CONTENTS | 2 |
| WARNINGS | 3 |
| EQUIPMENT | 4 |
| DESCRIPTION | 6 |
| PRESET | 7 |
| CROSSOVER FREQUENCY | 10 |
| ACCESSORIES | 11 |
| ARRAY EQ | 16 |
| MAINTENANCE | 17 |
| TECHNICAL SPECIFICATIONS | 20 |
| USER NOTES | 21 |

EU Conformity declaration

We, **NEXO SA**
ZA DU PRE DE LA DAME JEANNE
60128 PLAILLY – France

Declare under our sole responsibility that the product **Loudspeaker**

Type **ID84 / ID84L**

Serial number **On the product**

Is in conformity with the provisions of the following directive **2014/35/UE (Low Voltage Directive)**
including all applicable amendments:

Applied rules and standards: **EN 12100, EN 13155, EN 62368**

Plailly, 01 June, 2021 **Joseph CARCOPINO, R&D Director**



WARNINGS

PRECAUTIONS

Do not open the speaker, do not try to disassemble it neither to modify it in any way. The system doesn't include any user-repairable part.

If the system seems to be malfunctioning or damaged, stop using it at once and have it repaired by a NEXO qualified technician.

Do not expose the system directly to the sun or to the rain, do not immerse it into fluids, do not place objects filled with liquid on the system. If a liquid gets into the system, please have it inspected by a NEXO qualified technician.

When flying outdoor systems ensure that the system is not exposed to excessive wind or snow loads and is protected from rainfall.

In case of wind greater than 8 on Beaufort scale (72km/h – 45mph), a touring system has to be landed or an additional securing has to be implanted.

For fixed installations, wind loading has to be taken into account in accordance to the national standards

The connection should be performed by qualified technician, by ensuring that power is off.

Operating temperature with temperate climate: 0°C to +40°C (+32°F to +104°); -20°C à +60°C (-4°F to +140°F) for storage.

SAFETY INFORMATIONS

Read this manual before using the speaker.

Keep this manual available for further reference.

Observe all warnings and cautions.

Please check the NEXO Web site nexo-sa.com to get the most up-to-date version of this manual.

Ensure you are aware of the safety rules applying to rigging, stacking or installing on tripod or speaker stand. Failure to observe these rules may expose persons to potential wounds or even death.

Only use the system with accessories specified by NEXO.

Please always consult a NEXO-accredited technician if the installation needs architectural works and observe following precautions:

Mounting Precautions:

- Please select screws and mounting location supporting 4 times the system weight.
- Do not expose the system to excessive dust, vibrations, to extreme cold or hot temperatures, to reduce the risk of damaging components.
- Do not place the system in an unstable position: it could fall accidentally.
- If the system is used on a tripod, please ensure the tripod's specifications are adapted and that its height does not exceed 1.40m/55". Do not move the tripod with the system in position.

Connection and Powering Precautions:

- Unplug connected cables before moving the system.
- Power off the system before connecting the system.
- When switching on the installation, the amplifier must be powered last; when switching the installation off, shut off the amplifier first.
- If you work by cold temperatures, progressively raise the level to nominal value during the first minutes of use, to allow the system components to stabilize.

Please check regularly the system condition.

HIGH SOUND PRESSURE LEVELS

Exposure to very high sound pressure levels may cause permanent hearing losses. Degrees of hearing losses may be different from one person to another, but almost everybody will be affected if exposed to high sound pressure levels during a long period of time. The OSHA (Occupational Safety and Health Administration) American Agency specified the following maximal exposures:

| Number of Hours | Sound Pressure Level (dBA), Slow Response |
|-----------------|--|
| 8 | 90 |
| 6 | 92 |
| 4 | 95 |
| 3 | 97 |
| 2 | 100 |
| 1 ½ | 102 |
| 1 | 105 |
| ½ | 110 |
| ¼ or less | 115 |

WASTE OF ELECTRIC OR ELECTRONIC EQUIPMENT



This symbol on the product or its packaging indicates that this product must not be treated as household waste. Instead, it is your responsibility to hand it over to a designated collection point for the recycling of waste electrical and electronic equipment. By ensuring your waste equipment is recycled, you will help prevent potential negative consequences for the environment and human health, which could appear if this product was not recycled. Recycling helps spare natural resources. For more information about the recycling of this product, please contact your local city office, your household waste disposal service or your reseller.

EQUIPMENT

Locations for hanging on the back.

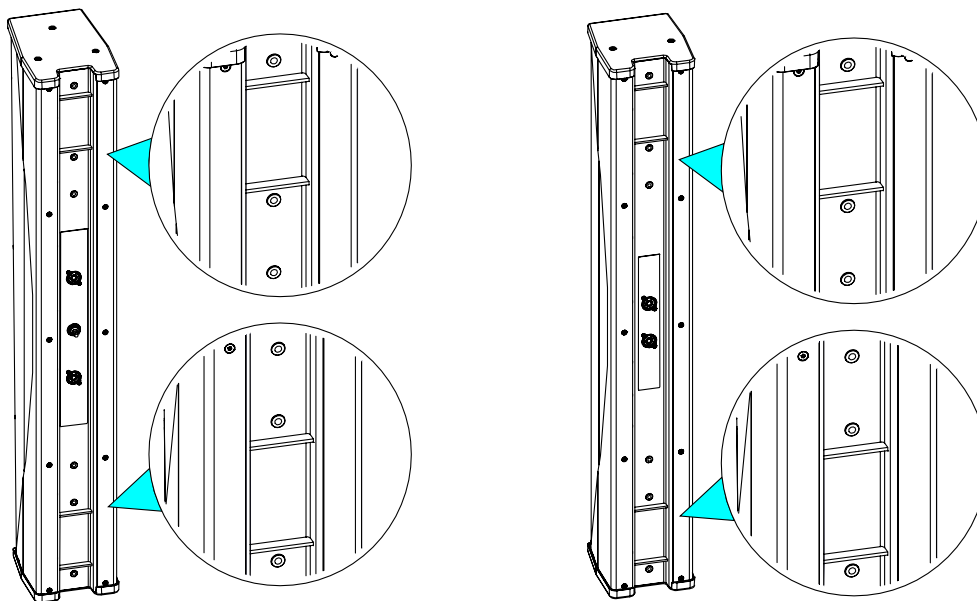

2 locations for connecting, 1 on the back and a quick connect in the base cover (ID84 only).

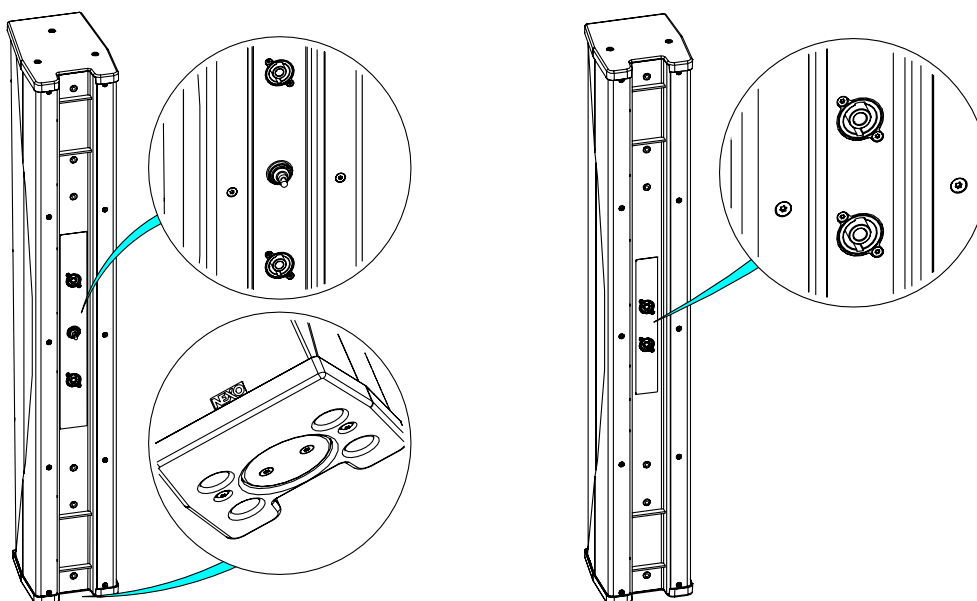

ID84 versions T & TIS: a directivity switch, located between the NL4 connectors, allows to virtually curve the drivers to achieve 2 vertical directivity patterns:

- Narrow (0° / -10°)
- Broad (0° / -25°)

WARNINGS

Do not use ID84 on the floor without using VNT-BP600 and IDT-BPADAPT.

Do not use ID84 on IDS312 on the floor without using VNT-BP600 and IDT-BPADAPT.

Assembly on ID84 / ID84L

Use IDU-COUPPL to assemble 2x ID84.

Use only fasteners provided (thread lock coated screws for permanent installation).

IMPORTANT

Use VNT-BP600 and IDT-BPADAPT for stacking.

Speaker must always be installed on a horizontal surface.

Stand height and footprint must be defined to prevent assembly from collapsing.

Ensure that audience is not allowed within a safety area which radius is equal or higher than assembly height.

Test steadiness of the assembly by pushing in all directions.

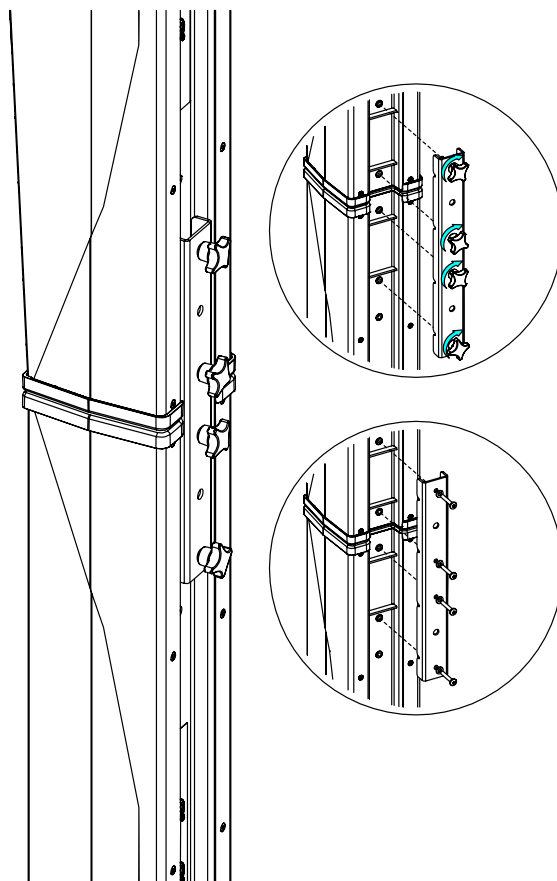

Assembly on IDS312

Open the trap above IDS312.

Place ID84 on IDS312, magnet keeps it in place

IMPORTANT

Speaker must always be installed on a horizontal surface.

Stand height and footprint must be defined to prevent assembly from collapsing.

Ensure that audience is not allowed within a safety area which radius is equal or higher than assembly height.

Test steadiness of the assembly by pushing in all directions.

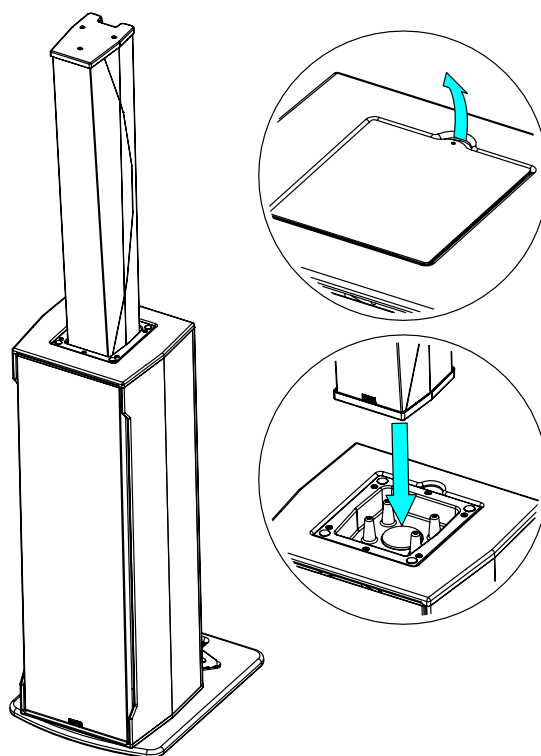

DESCRIPTION

DESCRIPTION

- ID84 is a column speaker, 2 ways passive
 - ID84L is a column extension speaker, increase directivity control in LF
 - Versions
 - ID84 / ID84L: for Touring Application; black, white
 - ID84-TIS / ID84L-TIS: for Touring Application, with Installation grille; black, white
 - ID84-I / ID84L-I: for Permanent Installation; black, white
 - ID84 Dispersion:
 - Horizontal: 100°
 - Vertical: +0°/-10° or +0°/-25°. Switch on the back
 - ID84 can be used alone or with ID84L and/or IDS312 subwoofer
 - ID84 / ID84-TIS / ID84L and ID84L-TIS are equipped with two NL4 connectors with parallel-wired pins. ID84 / ID84-TIS have a quick connect in the base cover to be connected with IDS312 / IDS312-TIS.
- ID84 / ID84-TIS use **2+/2-**. The 1+/1- pins are used by the sub.
- ID84L and ID84L-TIS use **1+/1-**.
- ID84-I and ID84L-I are equipped with a cable gland M16 (clamping range, Ø 5 to 12 mm), supplied with a fixed cable 2x 1.5 mm² section, length 2m, outside diameter 8mm ±1 mm

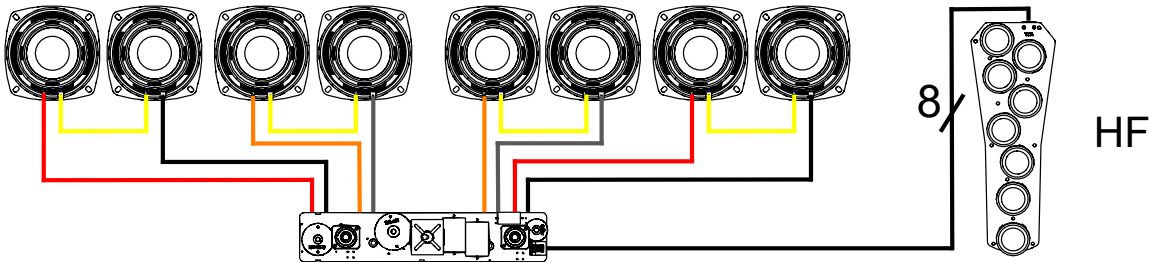

- Amplification
 - ID84/ID84L speakers must be used with a NEXO processor to handle EQ, phase alignment, crossover and excursion/thermal protection for the system loudspeaker.
 - The following table shows the number of OD84, ID84L speakers and IDS312 subwoofers usable with each solution.

| | DTD + DTDAMP4X0.7 | DTD + DTDAMP4X1.3 | NXAMP4X1mk2 | NXAMP4X2mk2 | NXAMP4X4mk2 |
|--------|----------------------|----------------------|--------------------|--------------------|--------------------|
| ID84 | 1 per chanel | 1 per chanel | Up to 2 per chanel | Up to 2 per chanel | Up to 2 per chanel |
| ID84L | 1 per chanel | 1 per chanel | Up to 2 per chanel | Up to 2 per chanel | Up to 2 per chanel |
| IDS312 | | | 1 per chanel | 1 per chanel | 1 per chanel |

PRESET

Please consult nexo-sa.com for NEXO TD Controllers firmware information.

For optimal acoustic performance, follow these rules:

- Always use at least 1x ID84.
- Never assemble more than 4 cabinets.
- Never use more than 2x ID84 or 2x ID84L in a column assembly.
- 2xID84 can only be coupled upside-down for HF section continuity.
- Never link an ID84L to the top of an ID84.

For the ID84, the following setups are available:

→ NARROW: directivity 0° / -10° .

→ BROAD: directivity 0° / -25° .

Preset

- ID84 BROAD, with high pass at 90 or 120 Hz.
- ID84 NARROW, with high pass at 90 or 120 Hz.

For the ID84L, the following setups are available:

→ NARROW: use when next to an ID84 in NARROW mode.

→ BROAD: use when next to an ID84 in BROAD mode or when not directly attached to an ID84.

Preset

- ID84L BROAD, with high pass at 90 or 120 Hz.
- ID84L NARROW, with high pass at 90 or 120 Hz.

1x ID84

ID84 + IDS312

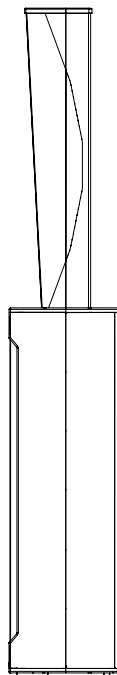

2xID84 / ID84 + ID84L

ID84

Switch and Set up:
NARROW or BROAD

ID84

Switch and Set up:
NARROW or BROAD



ID84

ArrayEQ HF: +3dB
Switch and Set up:
NARROW or BROAD

ID84L

Set up identical to ID84.



2xID84 + ID84L / 1x ID84 + 2xID84L**ID84**

ArrayEQ HF: +1.5dB

Switch and Set up:

NARROW or BROAD

ID84

ArrayEQ HF: +1.5dB

Switch and Set up :

NARROW or BROAD

ID84L

Set up identical to the ID84
directly above.

**ID84**

ArrayEQ HF: +4.5dB

Switch and Set up:

NARROW

ID84L

Setup NARROW

ID84L

Setup BROAD

CROSSOVER FREQUENCY

2xID84 + 2x ID84L

ID84

ArrayEQ HF: +3dB

Switch and Set up:

NARROW or BROAD

ID84

ArrayEQ HF: +3dB

Switch and Set up:

NARROW

ID84L

Setup NARROW

ID84L

Setup BROAD

ID84L

Set up identical to the ID84 just below it.

ID84

ArrayEQ HF: +3dB

Switch and Set up:

NARROW or BROAD

ID84

ArrayEQ HF: +3dB

Switch and Set up:

NARROW or BROAD

ID84L

Set up identical to the ID84 directly above.

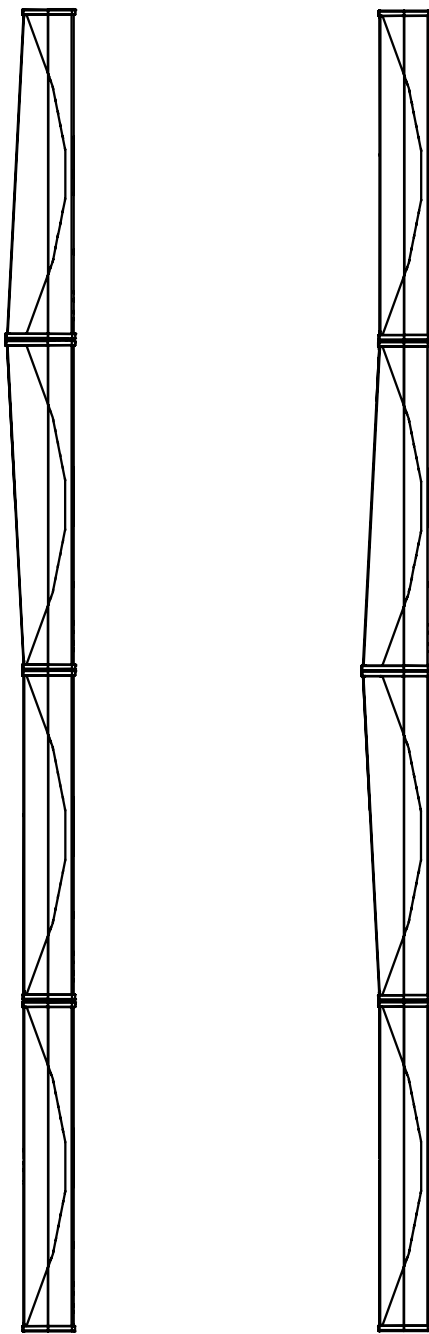

CROSSOVER FREQUENCY

- 90 Hz: Full range application.
- 120 Hz: Use with a NEXO subwoofer, e.g. IDS312.

ACCESSORIES

WARNINGS

All ID84 / ID84L accessories are specifically rated in agreement with structural computations.

Never use other accessories – including push-pins – when assembling ID84 / ID84L cabinets than the ones provided by NEXO: NEXO will decline responsibility over the entire ID84 accessory range if any component is purchased from different supplier.

PROHIBITED: ID84/ID84L below ID84/ID84L or ID84/ID84L with IDS312 without dedicated accessory

IDU-BUMP

Lifting bracket for ID84 / ID84L, can be used with VNT- LIFTADAPT or VNI-WMADAPT and VNI-WM200.

Up to 2x ID84 + 2x ID84L can be lifted.

For Touring use, place the knob through the part and screw the washer on it. Tight properly.

Refer to the Product Data Sheet

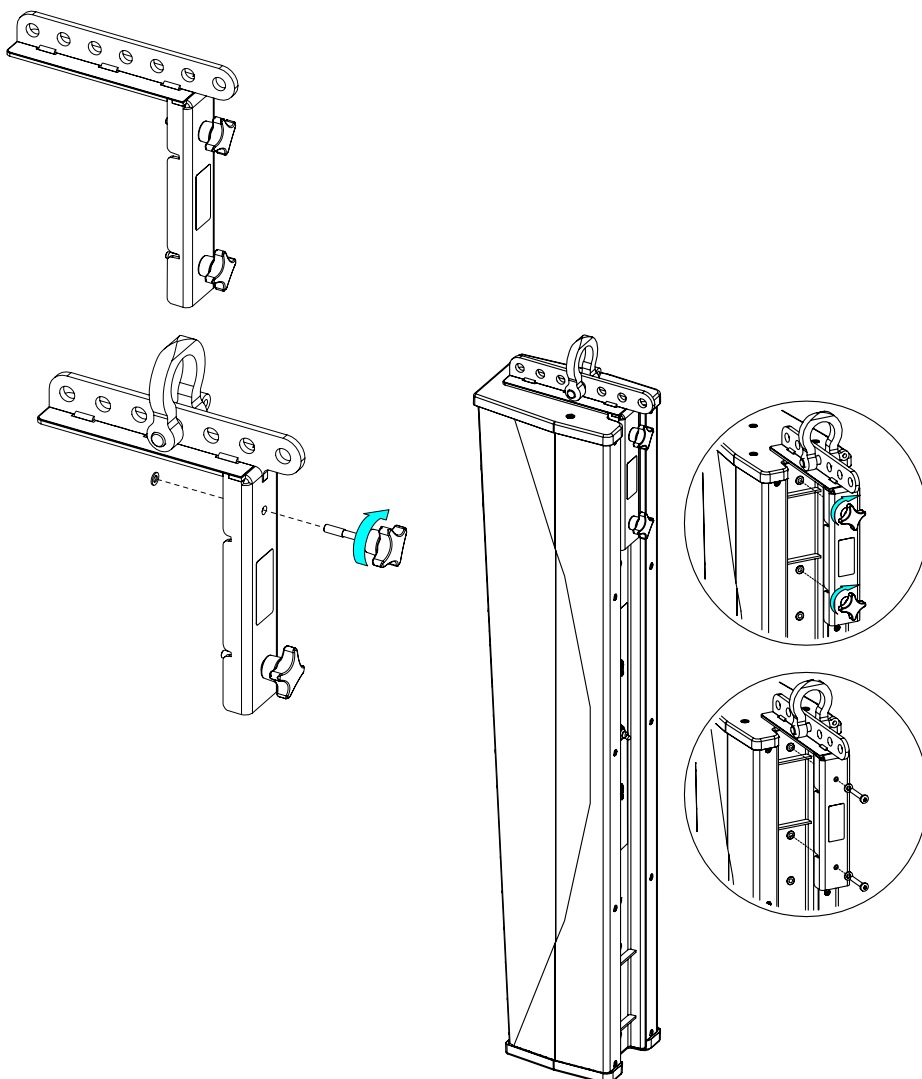

ACCESSORIES

VNT-TCBRK3551

Rotary Truss Clamp

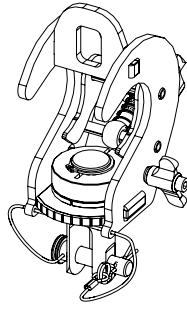

Place VNT-TCBRK3551 on IDU-BUMP at the desired hole.

Refer to the Product Data Sheet

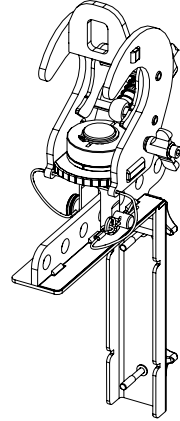
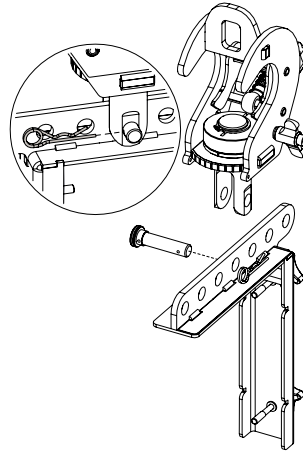

IDT-PLADAPT

Pole stand accessory for ID84 to be use with 35mm pole.

Can be fixed to upper part of the ID84.

For 1x ID84.

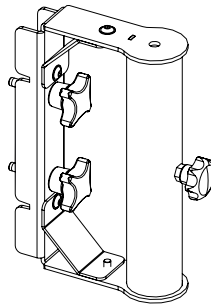

Place the accessory only in the upper position of the cabinet.

Tight properly.

Place the assembly on the pole stand, tighten the knob to maintain the desired orientation.

Refer to the Product Data Sheet

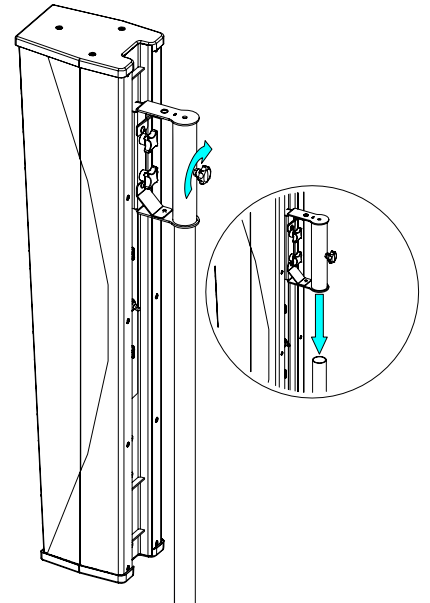
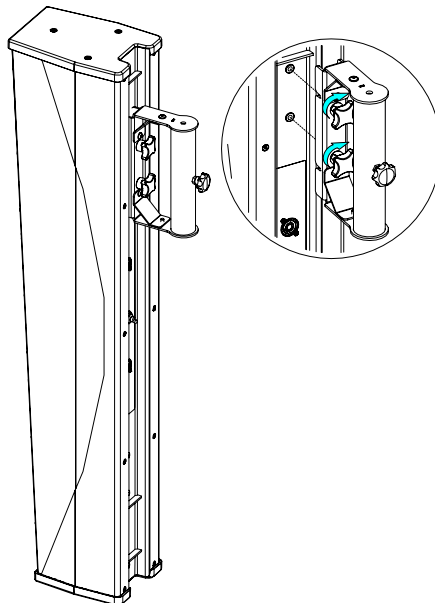

IDU-COUPPL

Coupling bracket for ID84

Up to 2x ID84 + 2x ID84L can be coupled together

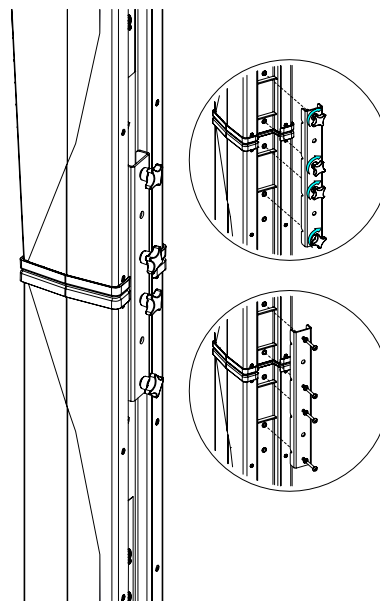
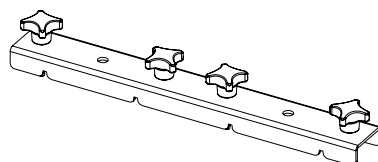

Tight properly.

Refer to the Product Data Sheet

IDU-TCBRK84

Truss-clamp bracket for ID84, to attach one or multiple ID84 to a truss, in horizontal or vertical arrangement.

1x TCBRK84 for a maximum of 2x ID84

2x TCBRK84 and additional hanging on IDU-COUPPL for a maximum of 2x ID84L + 2x ID84

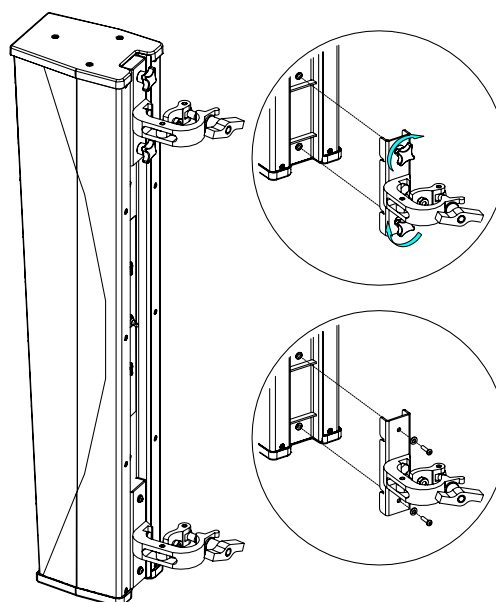
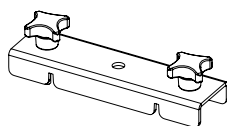

Place the accessory on the cabinet.

For permanent installation, use the provided thread lock coated screws.

Tight properly.

Refer to the Product Data Sheet

ACCESSORIES

VNT-BP600

Base plate for ID84/ID84L/IDS312, footprint M20 for extended bar.

IDT-BPADAPT must be used to secure ID84/ID84L/IDS312 to the base plate

- 1x ID84L + 1x ID84
- 1x IDS312 + 1x ID84

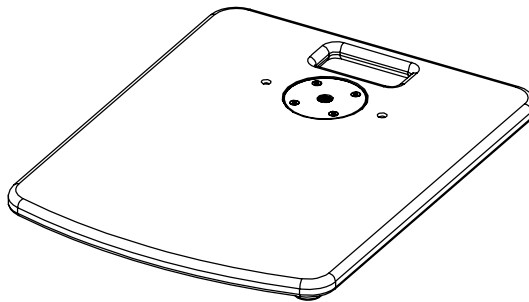

Refer to the Product Data Sheet

IDT-BPADAPT

Bracket for ID84/ID84L/IDS312, use to secure the assembly with VNT-BP600

- 1x ID84L + 1x ID84 (with IDU-COUPPL).
- 2x ID84 (with IDU-COUPPL).
- 1x IDS312 + 1x ID84 by using quick connect on IDS312.

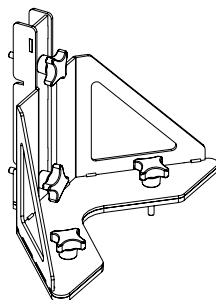

Attach IDT-BPADAPT to IDS312 or ID84, then place the assembly on VNT-BP600.

Tighten properly.

Refer to the Product Data Sheet

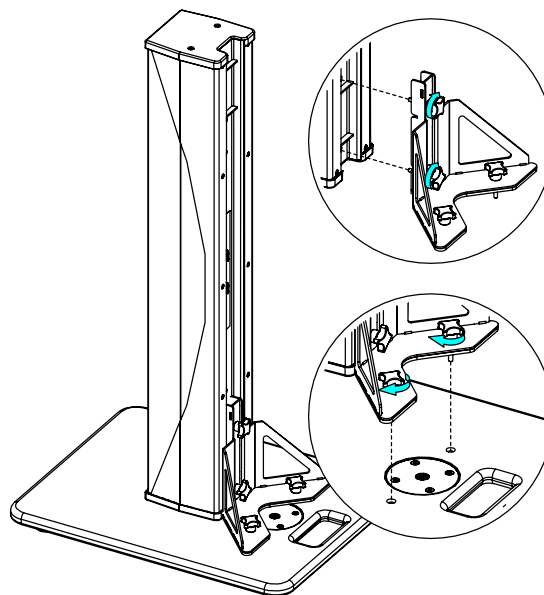

VNT-LIFTADAPT / VNI-WMADAPT

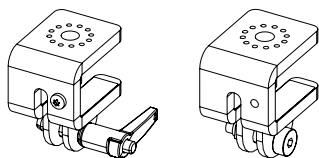

Max : 2xID84 + 2x ID84L

Refer to the Product Data Sheet

VNT-LIFTADAPT with IDU-BUMP

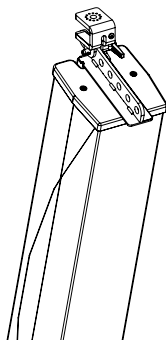

VNI-WMADAPT with IDU-BUMP & VNI-WM200

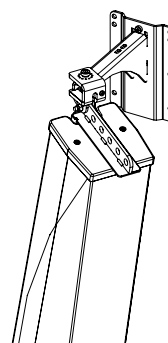

IDI-WB02 / VNI-WB02

Light Wall mount

Use 2x WB02 to hang 1x ID84 on a wall.

± 35° horizontal

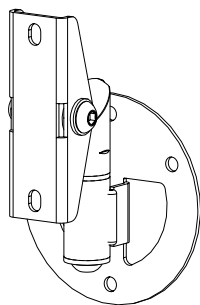

Fix the wall plates.

Place the M6 spacers between ID84 and WB02, fix the brackets on ID84.

Place the ID84 / WB02 assembly on the wall plates.

Tighten to lock the horizontal adjustment position.

Refer to the Product Data Sheet

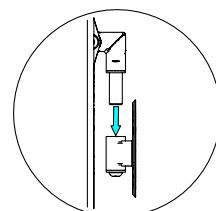
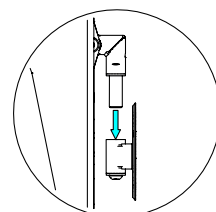
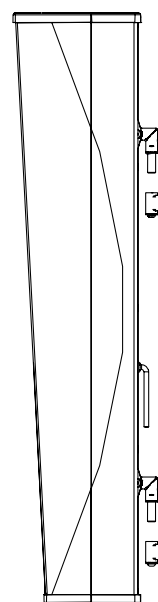
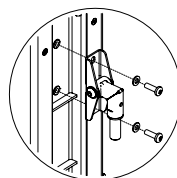
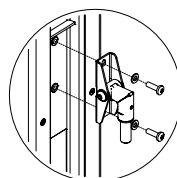
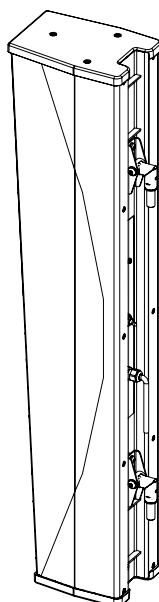
**IDI-WM02 / VNI-WM02**

Wall mount (up to 25 kg)

0° to -6° vertical and ± 50° horizontal

Can be fixed only on the upper hanging point of the ID84.

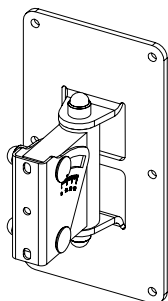

Tight properly.

Refer to the Product Data Sheet

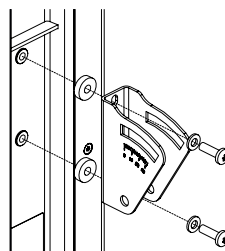

IDT-BAG84: transport bag for 1x ID84 ou ID84L

IDT-2CASE84: flight case for 2x (ID84 ou ID84L) + accessories (2x IDT-BUMP + 2x IDT-PLADAPT + 2x IDT-BPADAPT + 2x IDT-COUPPL + little storage)

ARRAY EQ

The ArrayEQ allows to adjust the system frequency response in its lower range
(see curves below, with different ArrayEq values):

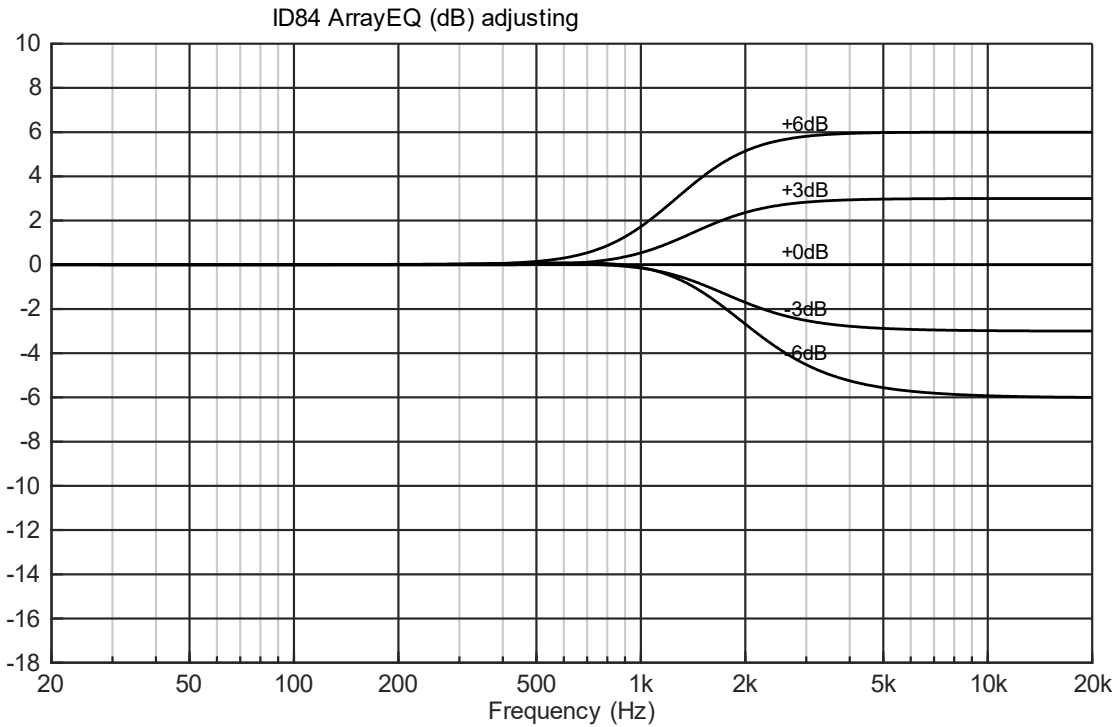
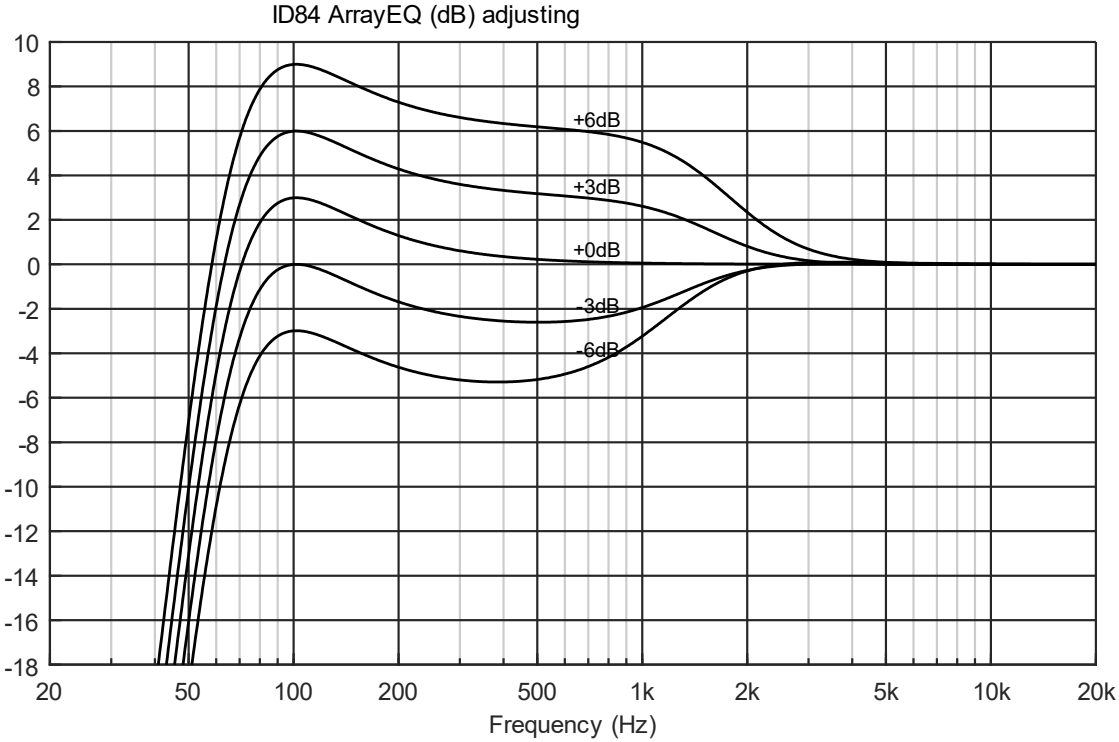

Apply the following array EQ HF **on all ID84** (not ID84L) of the assembly:

| | 1x ID84 | 2x ID84 |
|----------|---------------|---------------|
| 0x ID84L | No adjustment | No adjustment |
| 1x ID84L | +3dB | +1.5dB |
| 2x ID84L | +4.5dB | +3dB |

MAINTENANCE

Driver access

Remove the top cover (3 screws) and the bottom cover (2 screws). *Tx 15 – 20*
Tightening torque : 1.5Nm

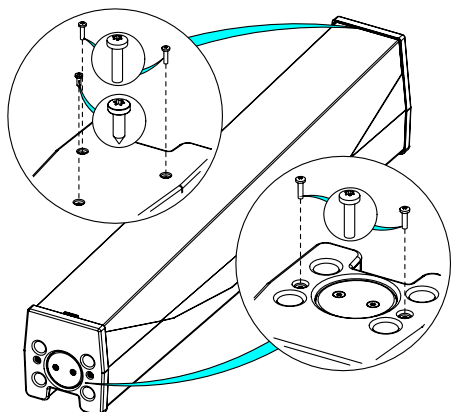

Remove the 14 screws and the both sides plates. *Tx 20. Tightening torque : 2.0Nm*
 Carefully, remove the grille.

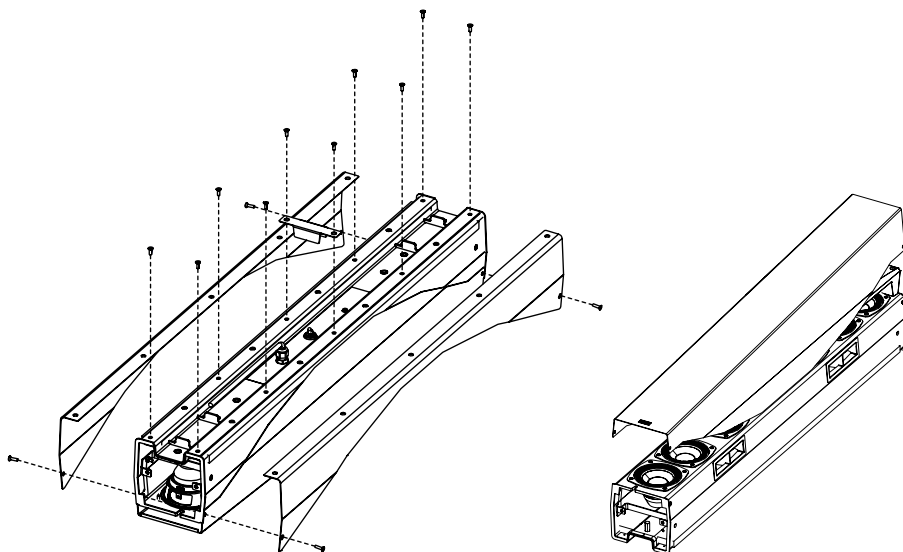

Remove the 4 screws and the RJ45 connector.
 Remove the HF assembly. *Tx20*
Tightening torque : 1.2Nm

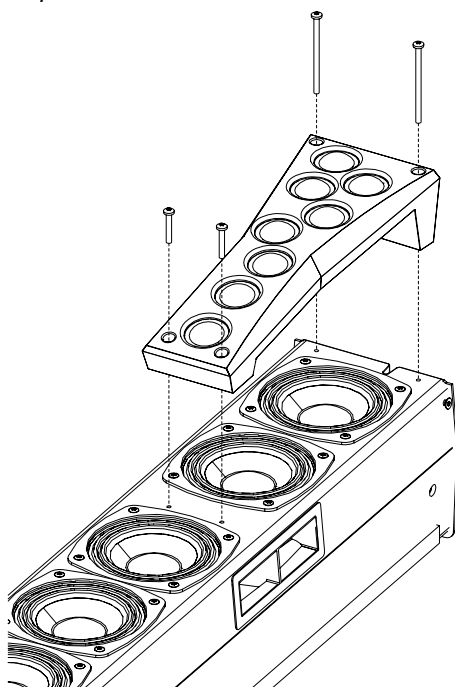

Remove the 4 screws to access the 4-inch driver. *Tx15*
Tightening torque : 1.0Nm

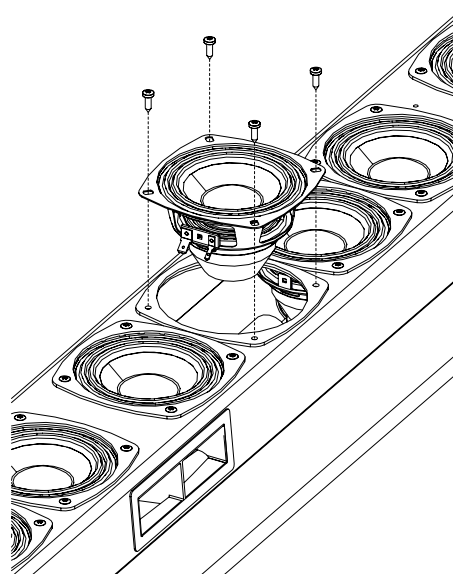

MAINTENANCE

Spare parts

ID84

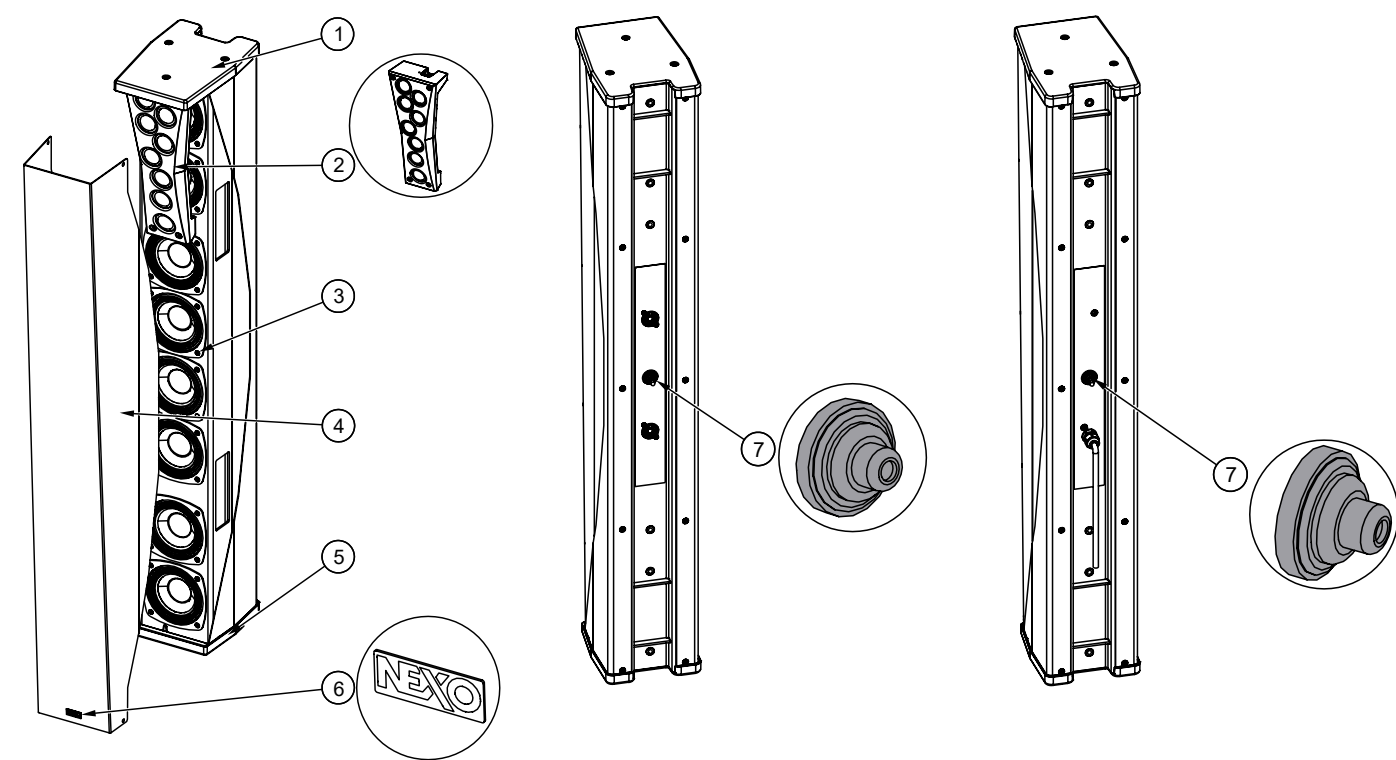

| MARK | QUANTITY | REFERENCE | DESIGNATION |
|------|----------|--------------|-----------------------------|
| 1 | 1 | 05ID84TOP | Top cover Black |
| | 1 | 05ID84TOP-PW | Top cover White |
| 2 | 1 | 05ID84HFC | HF assembly complete Black |
| | | 05ID84HFC-PW | HF assembly complete White |
| 3 | 8 | 05HPB4-8 | BASS DRIVER 4" 8 OHMS |
| 4 | 1 | 05ID84T-A | Grille ID84 Touring Black |
| | 1 | 05ID84T-APW | Grille ID84 Touring White |
| | 1 | 05ID84I-A | Grille ID84-I Install Black |
| | 1 | 05ID84I-APW | Grille ID84-I Install White |
| 5 | 1 | 05ID84QC | Quick connect Black |
| | 1 | 05ID84QC-PW | Quick connect White |
| 6 | 1 | 05LOGNEXO3 | Logo NEXO |
| 7 | 1 | 05CAPSWTCH-2 | Switch Cap Grey |

ID84L

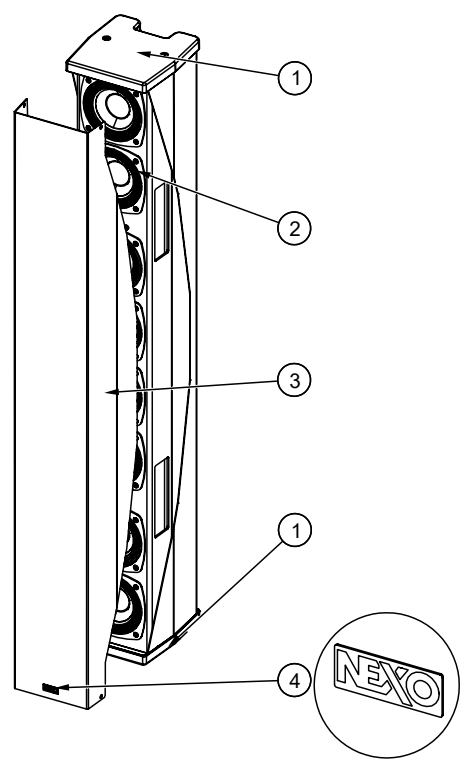

| MARK | QUANTITY | REFERENCE | DESIGNATION |
|------|----------|--------------|-----------------------------|
| 1 | 1 | 05ID84COV | Top cover Black |
| | 1 | 05ID84COV-PW | Top cover White |
| 2 | 8 | 05HPB4-8 | BASS DRIVER 4" 8 OHMS |
| 3 | 1 | 05ID84LT-A | Grille ID84L Touring Black |
| | 1 | 05ID84LT-APW | Grille ID84L Touring White |
| | 1 | 05ID84LI-A | Grille ID84L-I Instal Black |
| | 1 | 05ID84LI-APW | Grille ID84L-I Instal White |
| 4 | 1 | 05LOGNEXO3 | Logo NEXO |

TECHNICAL SPECIFICATIONS

ID84 / ID84L WITH NEXO ELECTRONICS

| Model | ID84 | ID84L |
|-------------------------------|----------------------|--|
| Frequency range (± 6 dB) | 90 Hz – 20 kHz | 90 Hz – 1500 Hz |
| Peak SPL Level (1m) | 135dB Peak | 132dB Peak |
| Operating voltage | 35Vrms (105Vpeak) | 35Vrms (105Vpeak) |
| Vertical directivity | +0°/-10° or +0°/-25° | Depends on ID84 Main module configuration and assembly |
| Horizontal directivity | 100° | 100° |
| Crossover Frequency | 90Hz – 120 Hz | 90Hz – 120 Hz |
| Nominal Impedance | 4 Ω | 4 Ω |

SPECIFICATIONS

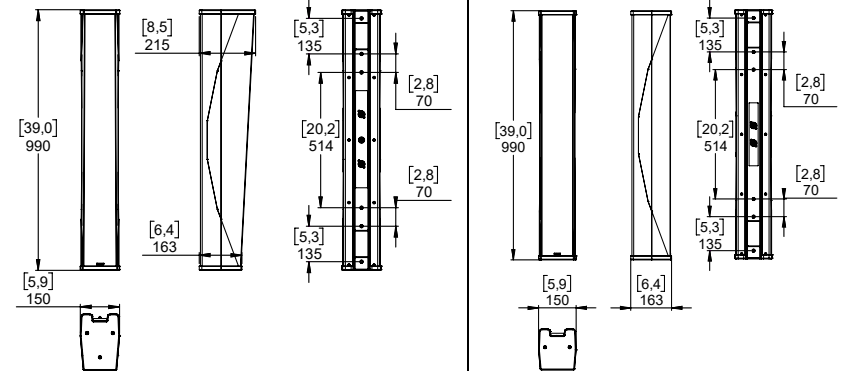
| Model | ID84 | ID84L |
|--------------|--|---|
| Components | LF: 8x 4" ; HF : 8x 1 " | LF: 8x 4" |
| Material | Aluminum body and Magnelis® covers and grille | |
| Finish | Black (RAL9005), white (RAL9016) powder coating or custom RAL | |
| Front finish | Magnelis® front grille Magnelis® front grille – Automotive grade front cloth (versions I and TIS) | |
| Fittings | Threated M6 inserts on the back | |
| Connector | 2x NL4, 4 poles connectors Quick connect in the base cover 1x cable gland with 2x core cable (version I) | 2x NL4, 4 poles connectors 1x cable gland with 2x core cable (version I) |
| Weight | 15 kg / 33 lb | 14 kg / 31 lb |
| Dimensions |  <p>The technical drawings show the dimensions for the ID84 and ID84L speaker modules. The ID84 module has a height of 990 mm (39.0 inches) and a width of 150 mm (5.9 inches). The ID84L module has a height of 990 mm (39.0 inches) and a width of 150 mm (5.9 inches). The drawings also show the dimensions for the grille and the base cover.</p> | |

USER NOTES

NEXO S.A.

Parc d'activité de la Dame Jeanne
F-60128 PLAILLY

Tel: +33 3 44 99 00 70
Fax: +33 3 44 99 00 30
E-mail: info@nexo.fr

nexo-sa.com

