



+P series

Compact, high-output, point-source
loudspeaker and sub-bass cabinet

P12

L15



<https://nexo-sa.com>

Thinking. Inside the box.

NEXO





The point-source loudspeaker perfected



P12 can be deployed as a uniquely versatile wedge monitor

Building on NEXO's acclaimed expertise in compact, high-output, point-source loudspeakers, the P12 delivers pristine, full-range sound at even greater Sound Pressure Levels, along with unparalleled versatility, thanks to an ingenious system for varying HF coverage patterns.

An exciting synergy of sleek good looks and stunning performance, the P12 employs a custom 12-inch LF driver and 3-inch diaphragm HF driver in a coaxial configuration to deliver perfect phase alignment, exceptional clarity and a smooth response across the full frequency range. Available in mobile and install versions, the curved, low profile cabinet can be deployed both vertically or horizontally (as a wedge monitor), and features pole-mounting hardware and rigging points, along with Active/Passive switching.



Active / Passive switching

The L15 sub is an ideal partner for the P12, extending LF performance down to 40Hz, while NEXO's NXAMP4X2MK2 delivers the perfect power and processing solution, combining multi-channel, high powered, networkable amplification with sophisticated loudspeaker control and protection. Linear phase presets for P12/L15 and the full range of NEXO cabinets make it quick and easy to configure a 'Plug & Play' solution for any system.

With the P12, musicians, DJs and event organisers can expect extraordinary performance from a compact system, while production and rental companies look set to enjoy the industry-leading levels of return on investment upon which the reputation of NEXO point-source loudspeakers are built.



The L15 sub extends LF response down to 40Hz



138dB Peak SPL
(Passive Mode)



Variable
HF Directivity



Low-Profile
Cabinet

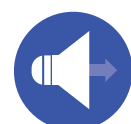

Coaxial 12" LF/
3" Diaphragm HF Driver



Active/Passive
Switching



Touring/Install
Versions

Variable HF Directivity

A few moments is all it takes to optimise the P12 for your application



Optional Magnetic Flanges

The dispersion characteristics of the P12 can be changed in seconds through the addition of optional magnetic flanges. The standard cabinet uses a 60° x 60° horn with additional 90° x 40° and Asymmetrical (PS Type) 60° - 100° x 40° also available.

The NXAMP4X2MK2 powered controller provides dedicated presets for each configuration, ensuring optimised coverage at any frequency. Results are even better in Active mode, where the crossover frequency can be adapted to offer the best coverage.

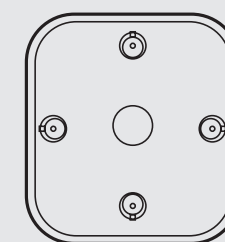

Standard Horn Profile
60° x 60° Dispersion

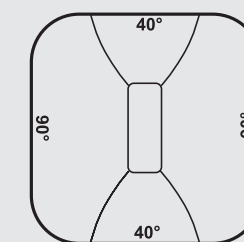

90° x 40° Horn Flange
Rotatable

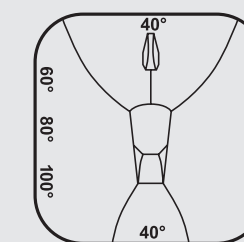

Asymmetrical (PS Type)
60° to 100° x 40° Dispersion

Advanced cabinet design with quick-release steel grille

Changing the flanges is easy and requires no tools – the quick-release steel grille can be removed in seconds providing full access to the horn.

With a fully symmetric design, there are no left or right versions of the P12, so inventory requirements are significantly streamlined. The cabinet is built around a 15mm custom-profiled plywood shell, using poplar veneer for the inner layers and birch on the outside to ensure strength, rigidity and light weight. Bass-reflex tuning is achieved through two computer-optimised ports to deliver ultra-low distortion, even at very high output levels.

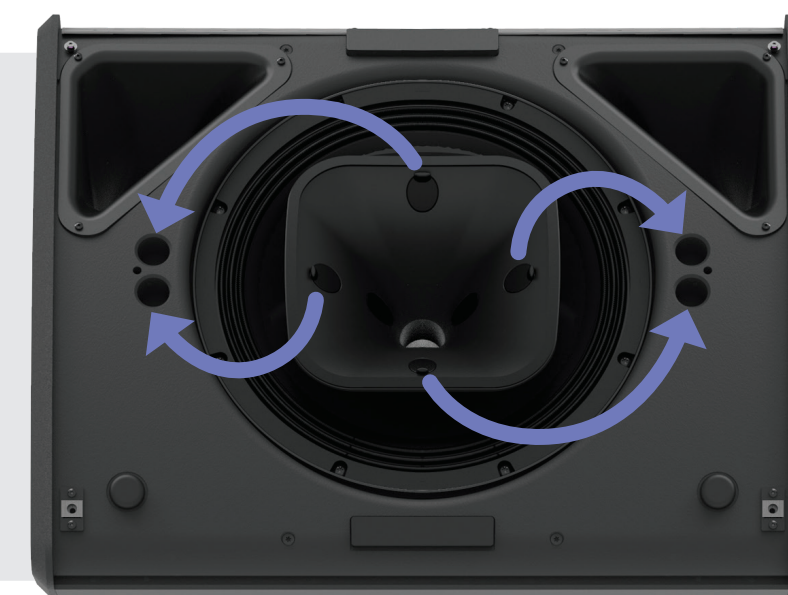

Bringing precision, high-output performance to a range of fixed and mobile applications

The facility to change the HF directivity makes the P12 an extremely flexible speaker in a range of mobile and fixed applications. But it's when deployed as a wedge monitor that the P12 becomes uniquely versatile, as sound engineers and rental companies can quickly 'tune' the HF coverage to suit the musician: Wide for guitarists or narrow for brass sections, while a P12 on an L15 sub creates a perfect drum fill monitor.

DJ

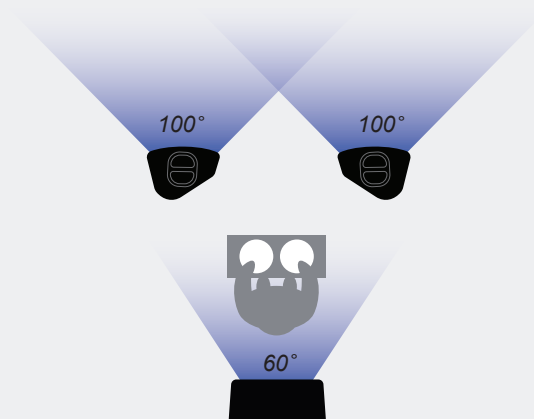

Small Club: 2 x P12 with 'PS Horn' for FOH, 1 x P12 with standard horn for monitor

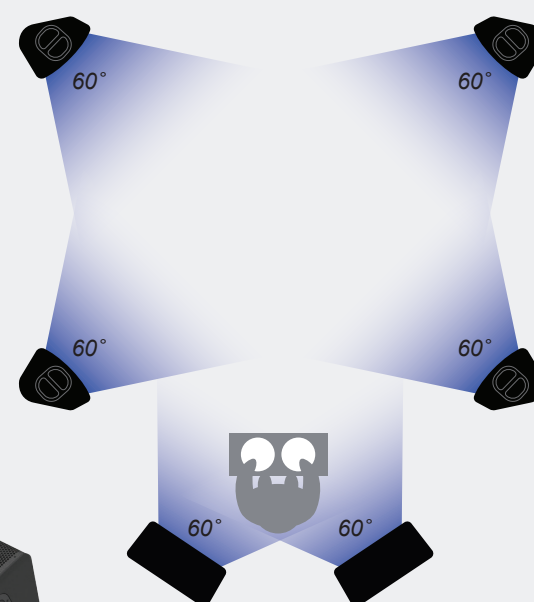

Large Club: 4 x P12 located in each corner of the room, with 2 x P12 as monitors – all standard horns

Music

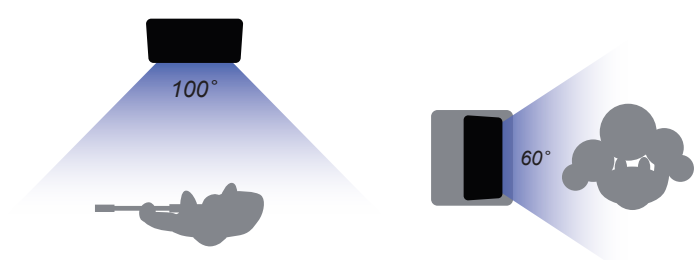

Guitarist Monitor: P12 wedge with 'PS horn' reversed

Drum Fill: P12 wedge with standard horn on L15 sub

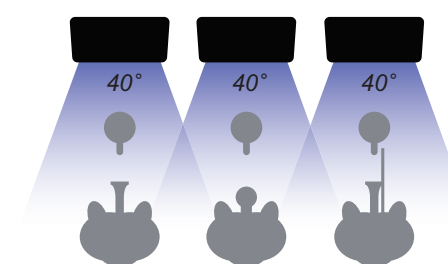

Bass Section Monitors: P12 wedges with 90° x 40° horn for narrow horizontal coverage

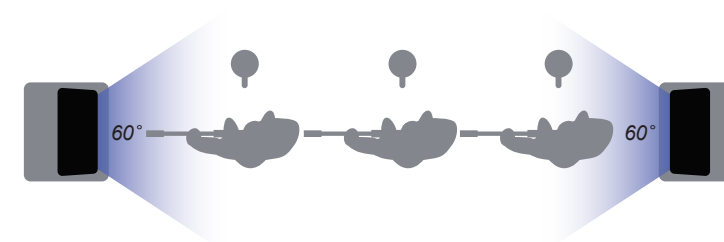

Side Fills: P12 wedges (standard horn) on L15 subs on each side

Events



Simple System: 2 x P12 with standard horn

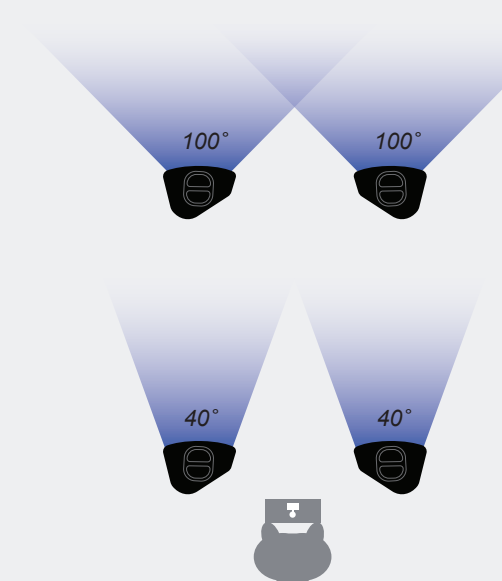

Long Throw System: 2 x P12 + 2 x P12 delayed – all with 'PS horn'

Recommended systems

NXAMP4X2MK2 delivers the perfect power and processing solution for P12/L15 systems in a variety of configurations

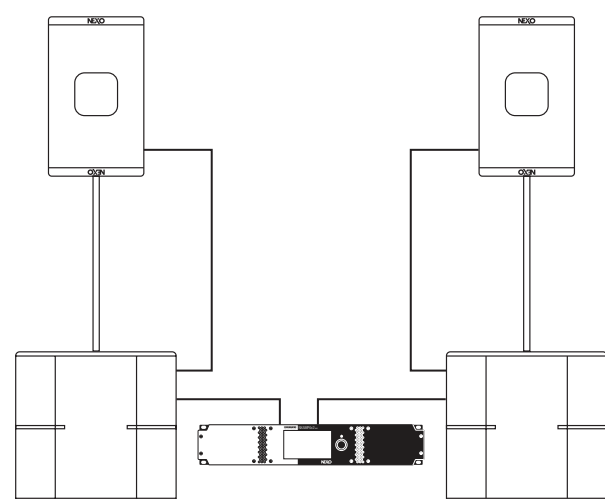

Stereo System: 1 x P12 (Passive) with pole stand on 1 x L15 Sub per side

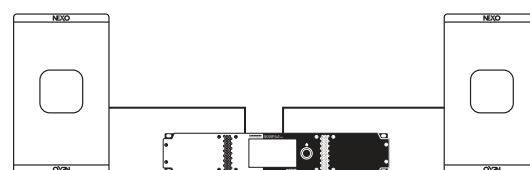

Active System: Stereo, 1 x P12 (Active) per side

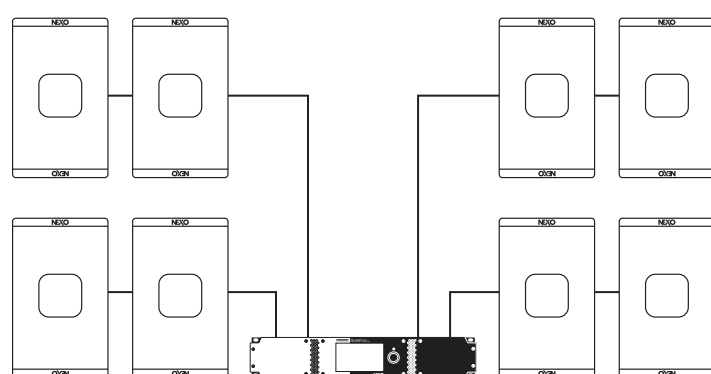

Distributed System: 8 x P12 (Passive) – 2 per amplifier channel

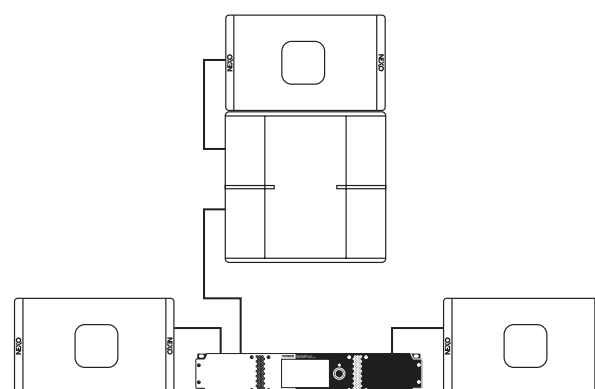

Monitor System: 1 x P12 Wedge on 1 x L15 Sub (Drum Fill) + 2 x P12 Wedges

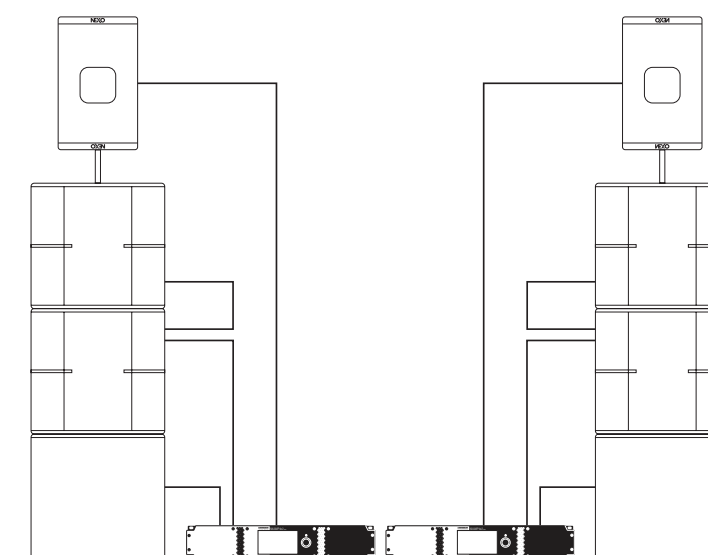

Mid-Sized FOH System: (Per side) 1 x P12 (Active) on 2 x L15 Subs on 1 x L15 Sub (Cardioid Mode)



NXAMP4X2MK2

NXAMP4X2MK2: The perfect power and processing partner

Rated at 4 X 2500 Watts, the NXAMP4X2MK2 combines advanced signal processing with four state-of-the-art Class D amplifiers to create a flexible, light-weight powering and control solution that's perfect for use with P12/L15 systems. Easy to set up and quick to deploy, all essential parameters are readily accessible via a large colour touch-screen on the front panel, with a comprehensive range of control and networking facilities on the rear panel. 32-bit/96KHz converters and 64-bit signal processing combine to assure pristine sound quality.

NeMo

Ether[®]
ES
Sound

Dante[™]

AES/EBU[™]

Class D

4.3" display

Tactile screen

x2
Dual Ethernet Port

P/F/C

*optional

P12

Measuring 432mm wide x 531mm high x 317mm deep and weighing 20Kg, the P12 can be deployed in vertical or horizontal (wedge monitor) configurations, with HF directivity set to match the specific application. The back plate holds two other Speakon® connectors and a recessed switch to change the cabinet from 2-way passive to 2-way active (on Touring version only). The Installation version is passive only and has a cable gland with a 2 core cable for audio input to ensure IP54 protection index.



P12 cab in main (vertical) and wedge (horizontal) configurations

Specifications

| P12 with NEXO electronics | |
|------------------------------------|-------------------------------------------------------------------------------------------------------------------------------------------------------------|
| Frequency Response (+6 dB) | 60 Hz - 20 kHz |
| Peak SPL Level (1m) | 138dB Peak (Passive mode) / 140dB Peak (Active mode) |
| Operating Voltage | 55Vrms (150Vpeak) |
| HF Dispersion (according to horns) | 60°x60° - 90°x40° - Asymmetrical Dispersion 60° to 100°x40° |
| Crossover Frequency | 60 Hz - 85 Hz |
| Nominal Impedance | Active mode (8Ω LF, 8Ω HF) – Passive mode: 8Ω |
| Product Features | |
| Components | LF: 1x12" - 8Ω; HF: 1x3" - 8Ω - Neodymium driver |
| Material | Baltic birch / Poplar plywood |
| Finish | Black or white structural paint |
| Front Finish | Steel front grille + Back mesh |
| Fittings | Handle on both sides Threated inserts on the back and on both sides for connection of mounting accessories Stand fitting on both sides (35mm / 1"3/8) |
| Connector | 4x NL4, 4 poles connectors; 2 on the back and 1 on both sides |
| Weight | 20 kg / 44 lb |
| Height x Width x Depth | 531mm x 432mm x 317mm (20.9" x 17" x 12.4") |

L15

Measuring 650mm wide x 430mm high x 550mm deep and weighing 34Kg, the L15 sub employs a 15" long excursion driver in Baltic birch / poplar plywood cabinet with threaded inserts for mounting accessories and an M20 stand fitting.



L15 sub

Specifications

| L15 with NEXO electronics | |
|----------------------------|---------------------------------------------------------------------------------------------------------------------|
| Frequency Response (+6 dB) | 40 Hz - 120 Hz |
| Peak SPL Level (1m) | 139 dB Peak |
| Operating Voltage | 55Vrms (150Vpeak) |
| Crossover Frequency | 85 Hz - 120 Hz |
| Nominal Impedance | 4Ω |
| Product Features | |
| Components | 1x 15" – 4 ohms – Long excursion – Neodymium driver |
| Material | Baltic birch / Poplar plywood |
| Finish | Black or white structural paint |
| Front Finish | Steel front grille |
| Fittings | Handles on both sides Threated inserts on both sides for connection of mounting accessories Stand fitting M20 |
| Connector | 2x NL4, 4 poles connectors |
| Weight | 34 kg / 75 lb |
| Height x Width x Depth | 430mm x 650mm x 550mm (16.9" x 25.5" x 21.6") |

P12/L15 System Accessories

A full range of accessories is available for varying P12 HF directivity and for deploying P12/L15 in mobile and fixed applications.

Additional Accessories (not illustrated)

- LNT-COV15: Cover for L15 on wheelboard
- PNT-COV12: Cover for P12
- PNT-2CASE12: Flight Case for 2x P12
- PNT-ACC12: Flight Case for P12 accessories

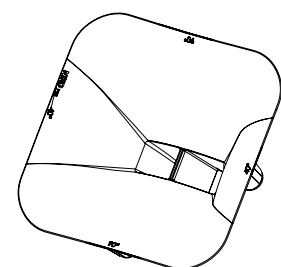

PNT-P12FLG9040
HORN Dispersion Adapter: 90° - 40°

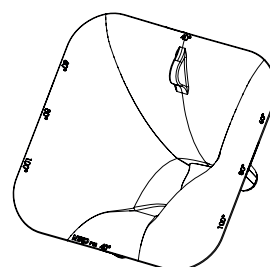

PNT-P12FLGPS
HORN Dispersion Adapter: PS

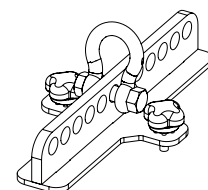

PNT-BUMP
LiftBar for P12, use with P12, WMADAPT

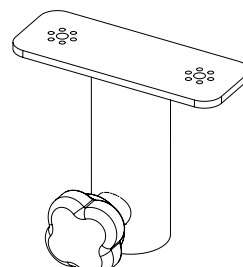

PNT-PLADAPT
Pole Stand Adapter, use with P12, HBRK12, VBRK12

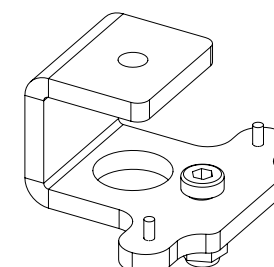

PNI-CLADAPT
Ceiling Adapter, use with HBRK12/VBRK12

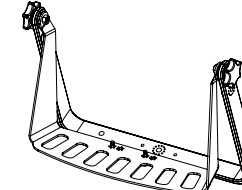

PNT-VBRK12
Vertical Cradle, use with CLADAPT, PLADAPT

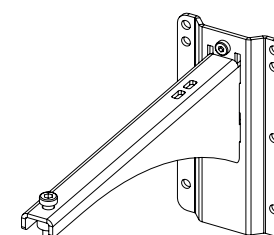

PNI-WM330
Wallmount L Bar for P12, with WMADAPT



PNT-WMADAPT
Wall Mount Adapter for PLUS series

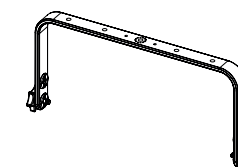

PNT-HBRK12
Horizontal Cradle, use with CLADAPT, PLADAPT

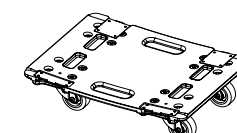

LNT-WB15
Wheelboard for L15

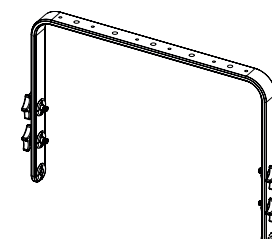

LNT-HBRK15
Horizontal Cradle for L15

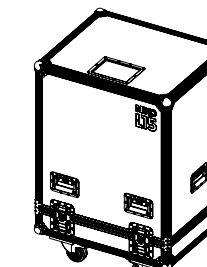

LNT-2CASE15
Flight case for 2x L15



Pseries

P12 L15

NEXO

Parc d'Activité
du Pré de la Dame Jeanne
B.P.5
60128 Plailly
FRANCE
Tel: +33 (0)3 44 99 00 70
Fax: +33 (0)3 44 99 00 30
E-mail: info@nexo.fr



<https://nexo-sa.com>

Thinking. Inside the box.

NEXO

